

Use Campagnolo, Sram or Shimano cable casing cap on compressionless outer casing

**15.50mm diameter at middle of boss
(tapered to fit chainstay)
Place on Columbus chainstay @ 85mm from rear
Llewellyn dropout axle centre**

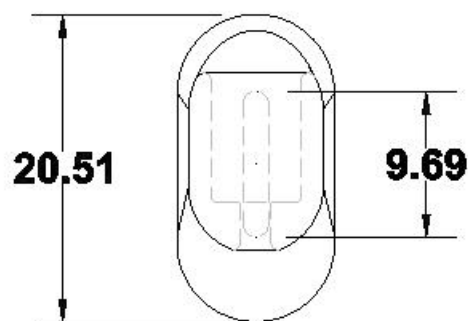

**"Limpets"
available in normal steel or stainless steel**

Silver braze insert groove

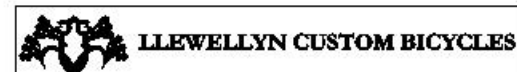

LLEWELLYN CUSTOM BICYCLES

Limpet chainstay gear cable stop

Drawn by Darrell L McCulloch Date 17/2/2012